

## 45404-GP

Load Capacity	425 lbs
Temp. Range	-40°F to 250°F

### Features

- Unground, non-precision
- Stamped metal construction
- Zinc plated mild steel
- Full ball compliment
- Front polymer seal
- Front and rear shields
- Shot guard
- Replaceable
- Grease packed

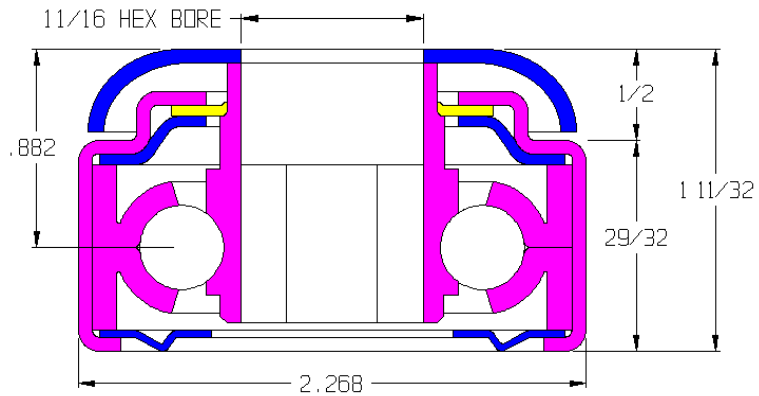

### Application Info

Recommended for mid-sized loads at slower speeds. A stamped metal shot guard fits in front of this bearing when installed which completely covers the bearing and deflects loose debris. Not effective in extremely dusty environments where the dust can float up under the shot guard. The bearing is lubricated with grease and can be used in powered applications as well as gravity applications. The grease adds rotational drag and is not recommended for gravity applications with very light products.

### Special Notes

102084-GP is the bearing part number.  
102210 is the shot guard part number.

