

NOTES:
 * ROLLER CAPACITY = 267 LBS.

(1) REQ'D

QTY	DESCRIPTION
1	TUBE: 1.9" OD X 16 GA. GALVANIZED
1	AXLE: 7/16" HEX MILD STEEL - SPRING RETAINED (ONE END)
2	BEARING: 115899-GP UNGROUND CRIMPED

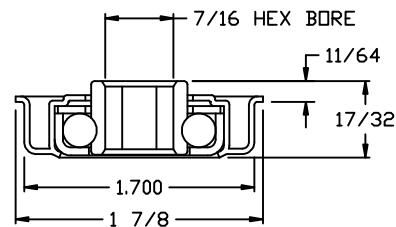

115899
 * UNGROUND CRIMPED
 * Load Capacity = 135 lbs
 * Temp. Range = -20°F to 140°F
 (Grease Packed Up To 350°F)
 * Max Speed = 200 rpm
 * Available in Oiled or Grease Packed
 * Non-precision
 * Stamped Metal Construction
 * Zinc Plated Mild Steel

OmniMetalcraft corp. ALPENA, MI U.S.A.
 (989) 358-7000

STANDARD ROLLER NUMBER: 26157-24

LABELED AS:

DRAWN BY: erinh
 DATE: 7/29/2016
 REF#: 1049055

DWG NO.
 Q8335-1