

115971-O

Load Capacity	140 lbs
Temp. Range	-40°F to 140°F
Max Speed	200 rpm

Features

- Unground, non-precision
- Stamped metal construction
- 300 series stainless steel body
- 400 series stainless steel balls
- Full ball compliment
- Lightly oiled

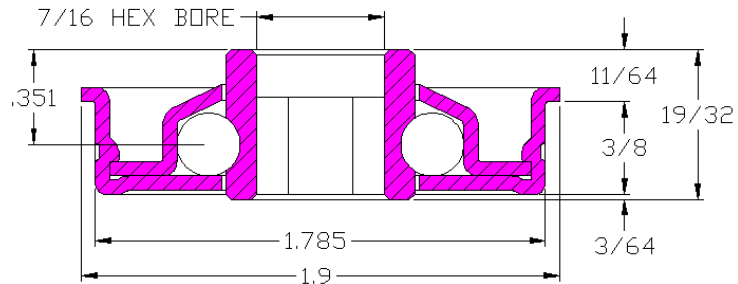

Application Info

Light oil offers very little rotational drag making this bearing highly recommended for gravity applications with light products. The body of the bearing is made from 300 series stainless steel to prevent rust and corrosion. The balls are made from 400 series stainless steel for tighter tolerances and higher load capacity. The lack of seals or shields reduces drag but offers no protection against dirt and debris. Not recommended for dirty or dusty environments. The light oil is not recommended for powered applications where the bearing is rotating continuously.

Similar Bearings

- 102160-O is zinc plated mild steel.
- 114210-GP is an equivalent poly-housed ABEC bearing.

Special Notes

- Standard oil is not food grade. Food grade grease available on request.
- 300 series stainless steel is not magnetic.

