

102309

Load Capacity	145 lbs
Temp. Range	-40°F to 140°F

Features

- Unground, non-precision
- Stamped metal construction
- Zinc plated mild steel
- Full ball compliment
- Stamped metal adapter
- Lightly oiled

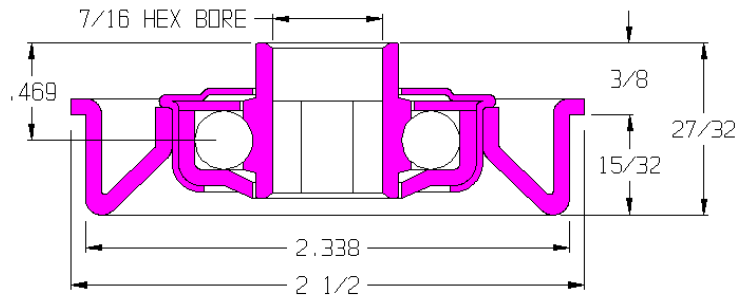

Application Info

Light oil offers very little rotational drag making this bearing highly recommended for gravity applications with light products. The lack of seals or shields further reduces drag but offers no protection against dirt and debris. Not recommended for dirty or dusty environments. The light oil is not recommended for powered applications where the bearing is rotating continuously. Not recommended for high speeds or CDLR.

Similar Bearings

102310 is sealed and grease packed.

Special Notes

102052-O is the bearing part number.

102058 is the adapter part number.

