

### 102259-GP

Load Capacity	135 lbs
Temp. Range	-20°F to 350°F
Max Speed	200 rpm

#### Features

- Unground, non-precision
- Stamped metal construction
- Zinc plated mild steel
- Full ball compliment
- Grease packed

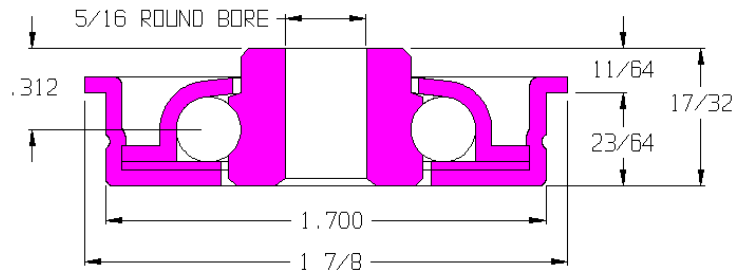

#### Application Info

Grease lubricates the bearing so it is recommended for lineshaft applications as well as gravity applications. The small bore size limits this bearing to very light-duty applications. Not recommended for moderate to heavy loads. The grease creates rotational drag so it is not recommended for extremely light weight gravity applications. The lack of seals or shields reduces drag but offers no protection against dirt and debris. Not recommended for dirty or dusty environments. Not recommended for high speeds or CDLR.

#### Similar Bearings

102259-O is lightly oiled.  
115899-GP has a 7/16 hex bore.

