

102042-O

Load Capacity	150 lbs
Temp. Range	-40°F to 140°F

Features

- Unground, Non-Precision
- Stamped metal construction
- Zinc plated mild steel
- Replaceable
- Lightly oiled

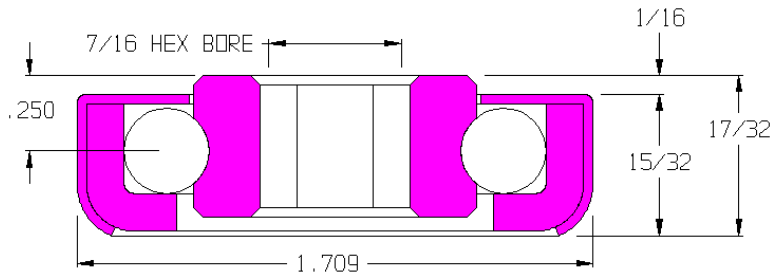

Application Info

Light oil offers very little rotational drag making this bearing excellent for gravity applications. The lack of seals or shields further reduces drag but offers no protection against dirt and debris. Not recommended for dirty or dusty environments. The light oil is not recommended for powered applications where the bearing is rotating continuously.

Similar Bearings

102042-GP is grease packed.
102051-O has a front labyrinth shield.

Special Notes

102051-O is recommended in place of this bearing because they are kept in stock.

