

### 102042-GP

Load Capacity	150 lbs
Temp. Range	-40°F to 300°F

#### Features

- Unground, Non-Precision
- Stamped metal construction
- Zinc plated mild steel
- Replaceable
- Grease packed

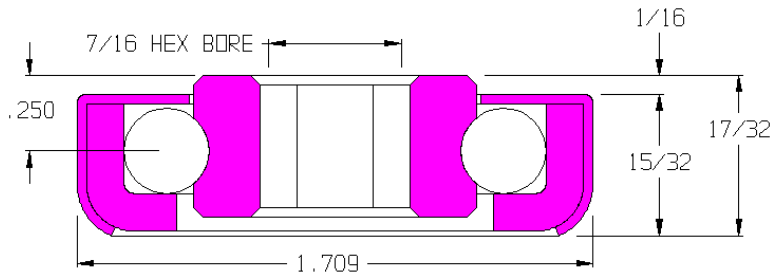

#### Application Info

Recommended for lineshaft and gravity conveyor applications. The lack of seals or shields reduces drag but offers no protection against dirt and debris. Not recommended for dirty or dusty environments. Not recommended for high speeds or CDLR.

#### Similar Bearings

102042-O is lightly oiled.  
102051-GP has a front labyrinth shield.

#### Special Notes

102051-GP is recommended in place of this bearing because they are kept in stock.

